

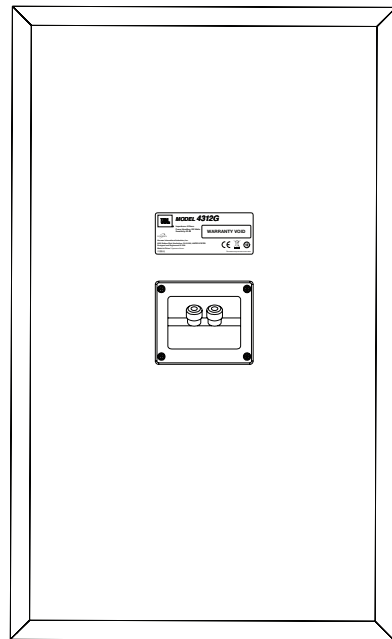

MODEL 4312G

12-Inch (300mm), 3-Way Studio Monitor

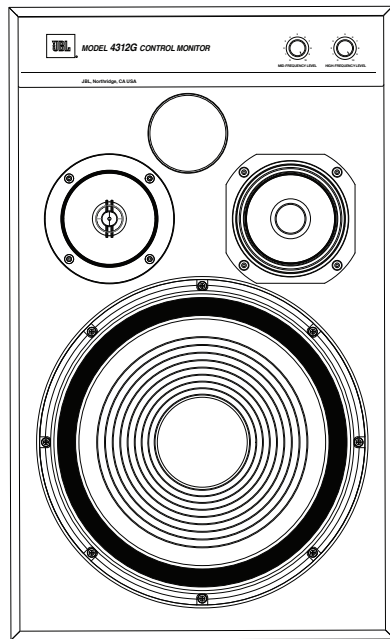

OWNER'S MANUAL

INTRODUCTION

Thank you for purchasing the **JBL® 4312G 3-Way Studio Monitor**.

For more than 70 years, JBL has been providing audio equipment for concert halls, recording studios and movie theaters around the world and has become the trusted choice of leading recording artists and sound engineers. The 4312G honors that legacy with the iconic 12-inch (300mm) 3-way configuration that dates back to 1968 with the original Model 4310 Control Monitor. Utilizing a compact monitor-type footprint, the 4312G features advanced JBL transducers including the JW300SW-8 Pure Pulp cone woofer, the JM125PC-8 Polymer-coated Pure Pulp cone midrange, and the 054ALMg-1 Aluminum/Magnesium Alloy tweeter.

PACKAGE CONTENTS

JBL 4312G loudspeakers are sold in mirror-image matched pairs. The outer carton serves to protect two internal cartons each containing a single loudspeaker with a removable grille.

PLACEMENT AND POSITIONING

CAUTION: The 4312G weighs 55.5 lb. (25.2 kg) each. Before placing the speaker on a shelf or platform, be sure that it is sturdy enough to support the speaker's weight.

Before deciding where to place your speakers, survey your room and think about placement, using the illustration below as a guide.

- Avoid placing the speakers near power amplifiers, heat registers or other objects that generate large amounts of heat.
- Do not place the speakers in very humid or dusty places.
- Do not place the speakers in direct sunlight or where they will be exposed to other strong light.
- For best results, place the speakers 6–8 feet (1.8-2.4m) apart. If you place the speakers farther apart than this, angle them toward the listening position.
- The speakers will produce the most accurate stereo soundstage when the angle between the listener and the speakers is between 40 and 60 degrees.
- Position each speaker so that its tweeter is approximately at ear level.
- Generally, bass output will increase as the speaker is moved closer to a wall or corner. For best performance, we recommend that you place the speakers at least 20 inches (50cm) away from the side walls.
- The 4312G may be stand mounted with the optional JBL metal stands (model JBL JS-120, sold separately) that angle the speaker upward.

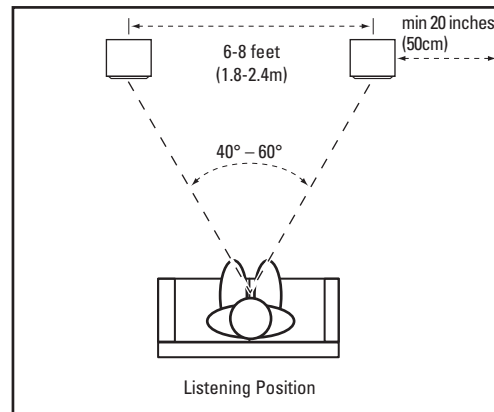

LEFT AND RIGHT PLACEMENT

The JBL 4312G is sold as mirror-image pair of loudspeakers with one having the tweeter on the left side and the other having the tweeter on the right side, yet neither one is marked or defined as a "LEFT" or "RIGHT" channel loudspeaker. Which one should be used for the left channel and which one should be used for the right channel will depend on a combination of factors including the listening distance from the speakers, the width of the room, acoustic reflectivity of the room, and horizontal versus vertical positioning of the loudspeaker.

It is typically best to position the loudspeakers to create a triangle of three equal sides when measuring the distances between the tweeters in each speaker and the distance from the listener to each tweeter. In smaller rooms or instances where the listening position is relatively close to the loudspeakers, this will usually result in the tweeters being positioned to the inside of the listening triangle. This positioning can also be desirable in a more acoustically reflective room or when the speakers are placed on a shelf or close to a side wall.

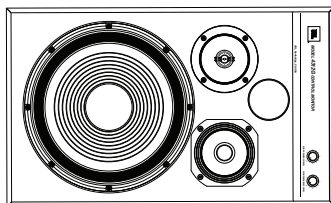
HORIZONTAL ORIENTATION:

Left Channel

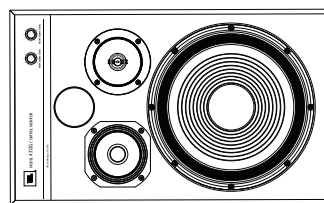

Right Channel

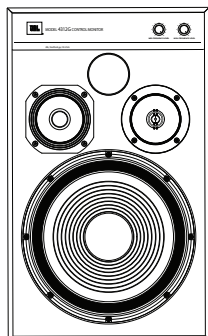
VERTICAL ORIENTATION:

Left Channel

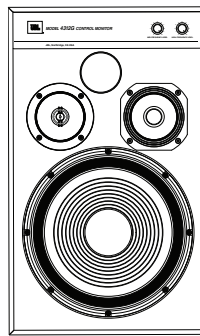

Right Channel

In larger rooms or instances where the listening position is relatively further away from the loudspeakers, this will usually result in the tweeters being positioned to the outside of the listening triangle. This positioning will result in a wider soundstage but may require slightly greater “toe-in” for the left and right channel speakers in order to maintain proper center imaging. This positioning can also be desirable in a more acoustically absorptive room or when the speakers are placed along the long wall of a rectangular dimension room.

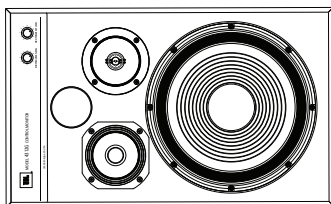
HORIZONTAL ORIENTATION:

Left Channel

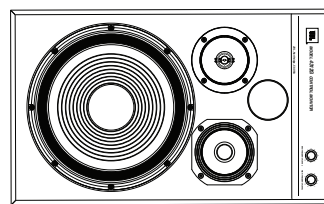

Right Channel

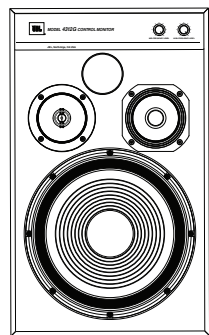
VERTICAL ORIENTATION:

Left Channel

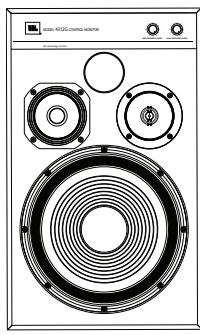

Right Channel

CONNECTIONS

CAUTION: Make sure that all of the system's electrical components are turned OFF (and preferably unplugged from their AC outlets) before making any connections.

Speakers and amplifiers have corresponding positive and negative (“+” and “-”) connection terminals. The 4312G has color-coded connection terminals. The “+” terminal is red, while the “-” terminal is black. See the illustration on the right.

The 4312G is designed so that a positive voltage at the “+” (red) terminal will cause the speaker drivers to move outward (toward the room).

We recommend using a high-quality speaker cable with polarity coding. The side of the cable with a ridge or other coding is usually considered positive polarity (“+”).

To ensure proper polarity, connect each “+” terminal on the back of the amplifier or receiver to the respective “+” (red) terminal on each speaker. Connect the “-” (black) terminals in a similar way. See your receiver or amplifier's owner's manual to confirm its connection procedures.

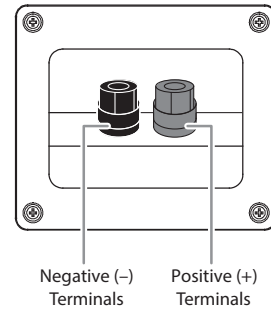

BASIC SINGLE-WIRE CONNECTION

Connect the amplifier to each speaker as shown in the illustration on the right.

IMPORTANT: Do not reverse polarities (i.e., “+” to “-” or “-” to “+”) when making connections. Doing so will cause poor stereo imaging and diminished bass performance.

The 4312G's gold-plated speaker terminals can accept a variety of wire connector types: bare wire, spade connectors, pin connectors and banana connectors.

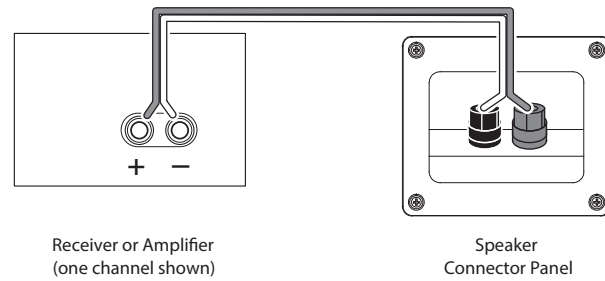

USING BARE WIRE OR PIN CONNECTORS:

IMPORTANT: Make sure that the (+) and (-) wires or pins do not touch each other or the other terminal. Touching wires can cause a short circuit that can damage your receiver or amplifier.

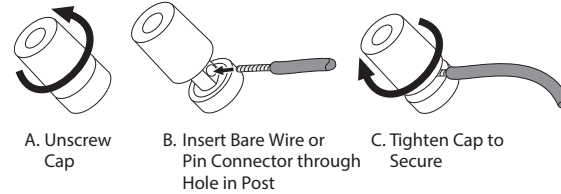

USING SPADE CONNECTORS:

IMPORTANT: Make sure the (+) and (-) spade connector blades do not touch each other or the other terminal. Touching blades can cause a short circuit that can damage your receiver or amplifier.

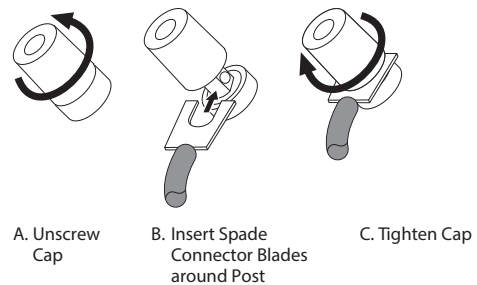

USING BANANA CONNECTORS:

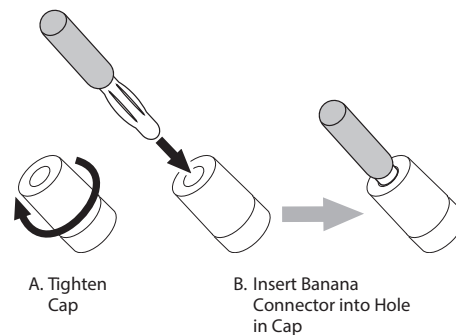

CONTROLS/ADJUSTMENTS

The 4312G has front-panel adjustments that let you balance the levels of the midrange driver (MF) and tweeter (HF) relative to the woofer.

You can use these controls to adjust the speaker's sound according to your room's acoustics, or your personal taste. The "center" default position is with the marks on the knobs pointing towards the number five.

As with most speakers, after you start playing the 4312G it will take the drivers' suspensions several weeks to "break in" and achieve optimum performance. During this period, the balance between the woofer, midrange and tweeter may change, so we recommend that you adjust the midrange and tweeter controls accordingly.

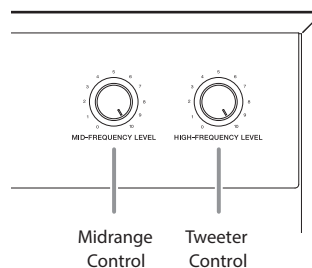

NOTE: There is a protective plastic film on the front control panel label. This may be removed upon installation.

CARING FOR YOUR SPEAKERS

- Wipe the cabinet with a clean, dry cloth to remove dust. Damp cloths or cleaning paper may dull the cabinet's finish.
- Do not use volatile liquids such as benzene, paint thinner, alcohol, etc., on the cabinet. Do not spray insecticide near the cabinet.
- To remove dust from the grille fabric, use a vacuum cleaner set to low suction.
- Do not wash the grille in water, as this may fade the color or make it uneven.
- If the surfaces of the woofer and midrange cones become dusty, you can carefully sweep them clean with a soft, dry calligraphy brush or paint brush. Do **not** use a damp cloth.
- NEVER touch **anything** to the tweeter dome.

SPECIFICATIONS

System Type	3-way Bass-reflex Monitor
Woofer	12-inch (300mm) Pure Pulp cone (JW300SW-8)
Midrange	5-inch (125mm) Polymer-coated, Pure Pulp cone (Model JM125PC-8)
Tweeter	1-inch (25 mm) Magnesium/Aluminum Alloy dome (054ALMg-1)
Impedance	6 ohms
Recommended Amplifier Power	10-200 Watts RMS
Sensitivity (2.83V/1m)	90dB
Frequency Response	44Hz-40kHz (-6dB)
Crossover Frequencies	640Hz, 5kHz
Controls	Attenuators for MF and HF Drivers
Connector Type	Five-way Binding Posts
Finish	Black Woodgrain with Black Grille
Dimensions (H x W x D)	23 1/2" x 14-1/4" x 12" (597mm x 362mm x 305mm)
Weight	52.4lbs (23.8kg) each

Please visit JBL.COM / JBLSYNTHESIS.COM for additional language support on the user manual.

Veuillez visiter JBL.COM / JBLSYNTHESIS.COM pour obtenir le mode d'emploi en d'autres langues.

Para obter o manual do usuário em outros idiomas, acesse JBL.COM / JBLSYNTHESIS.COM

Ga naar JBL.COM / JBLSYNTHESIS.COM voor de handleiding in andere talen.

Gå til JBL.COM / JBLSYNTHESIS.COM for bruksanvisning på flere språk.

Если вам требуется дополнительные версии руководства пользователя на других языках, посетите сайт JBL.COM / JBLSYNTHESIS.COM.

別の言語に対応したユーザーマニュアルを読むには、JBL SYNTHESIS.COMにアクセスしてください。

사용자 설명서에 대한 추가 언어 지원은 JBL.COM / JBLSYNTHESIS.COM에서 확인하십시오

请访问 JBL.COM / JBLSYNTHESIS.COM 以获取其他语言版本的用户手册。

Visita JBL.COM / JBLSYNTHESIS.COM para obtener el manual de usuario de soporte en idiomas adicionales.

Weitere Sprachfassungen der Bedienungsanleitung findest Du unter JBL.COM / JBLSYNTHESIS.COM.

Si prega di visitare JBL.COM / JBLSYNTHESIS.COM per i manuali di istruzioni in altre lingue.

Jos tarvitset ylimääräistä kieleen liittyvää tukea käyttöohjeesta, käy osoitteessa JBL.COM / JBLSYNTHESIS.COM.

Gå ind på JBL.COM / JBLSYNTHESIS.COM for at se betjeningsvejledningen på flere sprog.

Gå till JBL.COM / JBLSYNTHESIS.COM för mer information om språk i användarmanualen.

Торговая марка:	JBL
Назначение товара:	Пассивная акустическая система
Изготовитель:	Харман Интернешнл Индастриз Инкорпорейтед, США, 06901 Коннектикут, г.Стэмфорд, Атлантик Стрит 400, офис 1500
Страна происхождения:	Китай
Импортер в Россию:	ООО "ХАРМАН РУС СиАйЭс", Россия, 127018, г.Москва, ул. Двинцев, д.12, к 1
Гарантийный период:	1 год
Информация о сервисных центрах:	www.harman.com/ru тел. +7-800-700-0467
Срок службы:	5 лет
Срок хранения:	не ограничен
	Товар не подлежит обязательной сертификации
Дата производства:	Дата изготовления устройства определяется по двум буквенным обозначениям из второй группы символов серийного номера изделия, следующих после разделительного знака «-». Кодировка соответствует порядку букв латинского алфавита, начиная с января 2010 года: 000000-MY0000000, где «M» - месяц производства (A - январь, B - февраль, C - март и т.д.) и «Y» - год производства (A - 2010, B - 2011, C - 2012 и т.д.).

产品中有害物质的名称及含量

部件名称	目标部件	有害物质或元素					
		铅(Pb)	汞(Hg)	镉(Cd)	六价铬(Cr(VI))	多溴联苯(PBB)	多溴二苯醚(PBDE)
电路板	印刷电路板, 电路板上的电子零件 (不包括特定电子零件), 内部相关连接线	X	0	0	0	0	0
箱体	外壳, 面板, 背板等	X	0	0	0	0	0
特定电子零部件	变压器, 保险丝, 大型电解电容, 电源插座	X	0	0	0	0	0
附件	电线, 说明书, 包装等	X	0	0	0	0	0

本表格依据SJ/T 11364的规定编制

O: 表示该有害物质在该部件所有均质材料中的含量均在GB/T 26572 规定的限量要求以下。

X: 表示该有害物质至少在该部件的某一均质材料中的含量超出GB/T 26572规定的限量要求。



在中华人民共和国境内销售的电子电气产品上将印有“环保使用期”(EPUP)符号。圆圈中的数字代表产品的正常环保使用年限。





HARMAN International, Incorporated
8500 Balboa Boulevard, Northridge, CA 91329 USA

www.jblsynthesis.com

© 2018 HARMAN International Industries, Incorporated. All rights reserved.

JBL is a trademarks of HARMAN International Industries, Incorporated, registered in the United States and/or other countries.

Features, specifications and appearance are subject to change without notice.

CE Part No. 950-0560-001